

ER10-1600

EFORT

ER10-1600,
Maxium payload 10 kg with maxium reach 1640 mm.

■ **Highlights**

A comprehensive arc welding application software can be integrated to meet the requirements of automatic welding in various scenarios; Thanks to the high stiffness transmission design and advanced trajectory algorithm, the improved robot accuracy performance helps customers to face variety of application scenarios.

■ **Applications**

It can be used in handling, machine tending, arc welding, etc.

■ **Industries**

Suitable for plastic, metal parts and other industries.



EFORT INTELLIGENT EQUIPMENT CO.,LTD.

PHONE: (00 86) 400-052-8877

ADDRESS: No.96 East Wanchun Road, China(Anhui) Pilot

Free Trade Zone Wuhu Area, Wuhu, Anhui Province, China

WWW.EFORT.COM.CN

SPECIFICATIONS

Model	ER10-1600	
Type	Articulated	
Controlled axes	6 Axes	
Max. payload on wrist	10 kg	
Repeatability	±0.05 mm	
Robot weight	185 kg	
Reach	1640 mm	
Robot IP grade	IP54 / IP67 (Wrist)	
Cabinet IP grade	IP54	
Drive mode	AC servo drive	
Installation	Floor, Upside-down, Wall, Angle	
Installation enviroment	Ambient temperature	0~45 °C
	Ambient humidity	RH≤80% (No dew nor frost allowed)
	Vibration acceleration	4.9 m/s ² (<0.5 G)

Allowable load moment at wrist	J4	20 N·m
	J5	20 N·m
	J6	10 N·m
Allowable load inertia at wrist	J4	0.625 kg·m ²
	J5	0.625 kg·m ²
	J6	0.2 kg·m ²
Maximum speed	J1	170°/sec
	J2	160°/sec
	J3	180°/sec
	J4	330°/sec
	J5	360°/sec
	J6	600°/sec
Motion range	J1	±165°
	J2	+80°-135°
	J3	+163°-75°
	J4	±180°
	J5	±130°
	J6	±360°

OPERATING SPACE

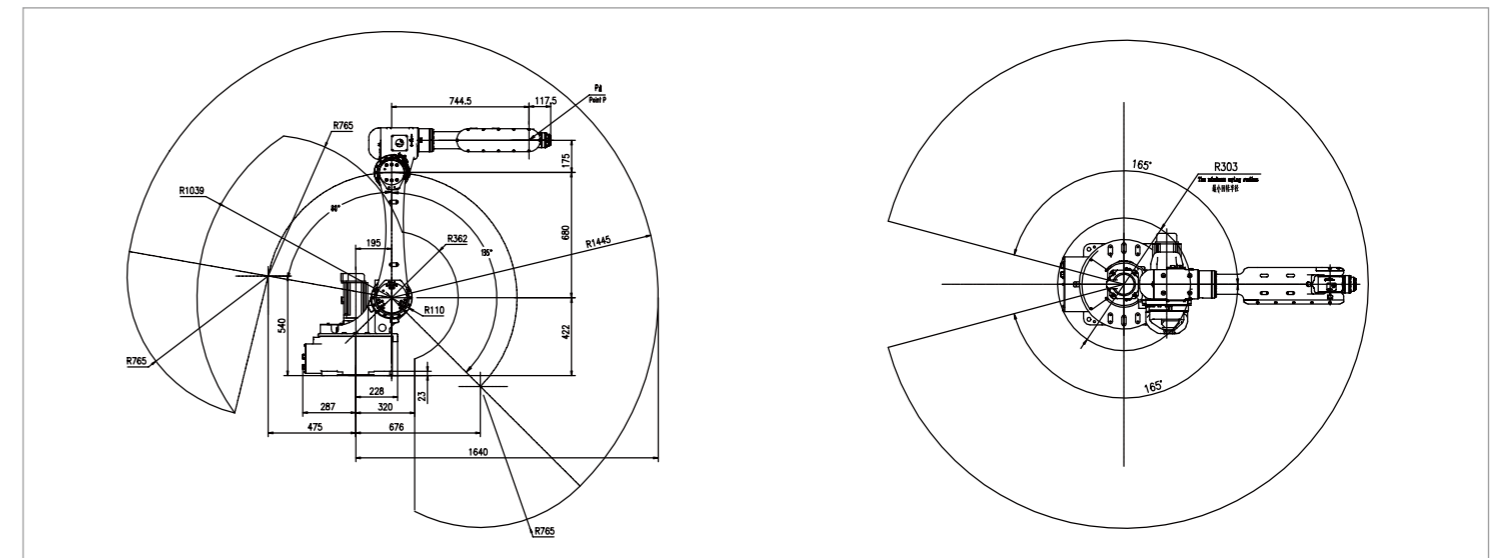

BASE MOUNTING SIZE

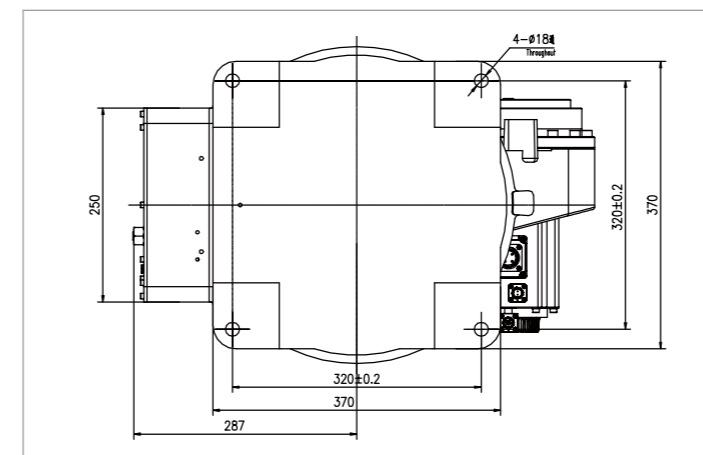

END FLANGE MOUNTING SIZE

